

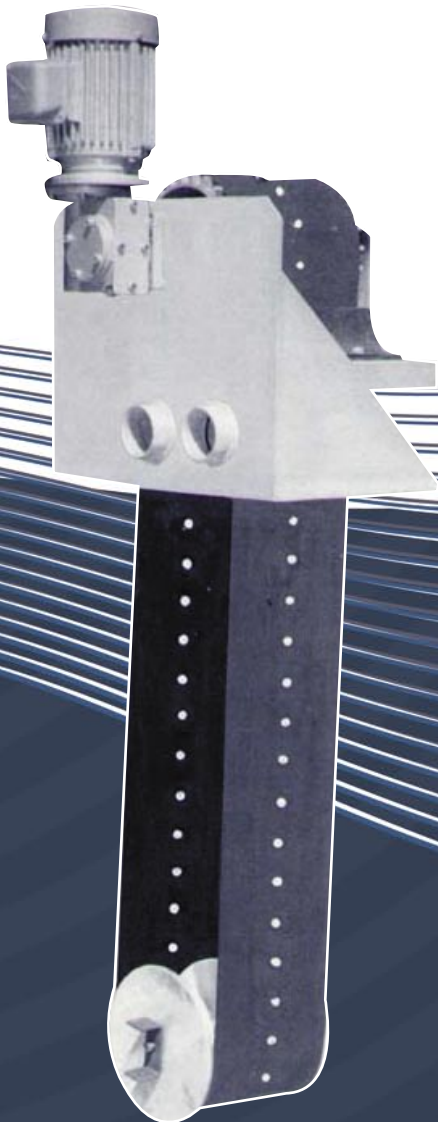

interfil

Surface Oil Skimming



INTERFIL 2000 Surface Oil Remover

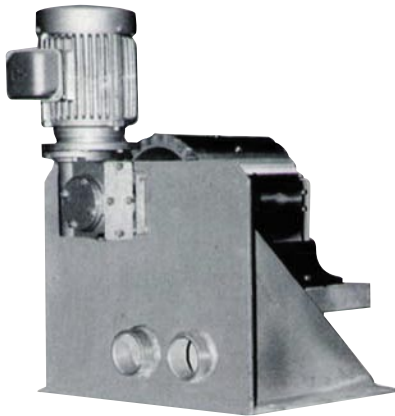

Operation

Surface Oil is naturally attracted to the stainless steel belt as it passes through the surface oil phase. Thus the INTERFIL 2000 is in effect, a continuous, vertically-oriented endless belt. The lower end or tail of the belt is designed to be always submerged in the liquid and the belt has suspended within the lower loop, a tail pulley.

The upper end of the continuous belt fits over a head or drive pulley and passes between two wiper blades which remove the oil, motor spirit, product or whatever is being separated by the stainless steel belt.

The removed material passes into a collection area and then into a sump which is part of the mild steel fabricated baseframe. The sump features two exit ports from which the oil may be disposed.

Because the Stainless Steel Belt is available in any length, and because the tail pulley is free-riding, the INTERFIL 2000 can be furnished to meet any height (or depth) requirements. For optimum operation, the tail pulley should be completely submerged.

Uses

Interfil 2000 is used to:

- Remove Oil and Grease from sullage drains
- Remove Tramp and Free Oils from coolant, cutting and processing liquids
- Remove Motor Spirit and Oils from wash pads and pits
- Recover Product from process and wash waters
- Remove Oily Wastes from settling tanks

Benefits

Interfil 2000 is used to:

- EASY TO INSTALL
- SIMPLE TO SERVICE
- CONTINUOUS IN OPERATION
- ECONOMICAL TO PURCHASE AND OPERATE
- EFFECTIVE - removes up to 10 litres/minute
- ELEVATES OIL FOR EASY DISPOSAL
- EFFECTIVE - operates regardless of changes in liquid height
- WEATHER RESISTANT - engineered to withstand the elements
- ENGINEERED as a complete system

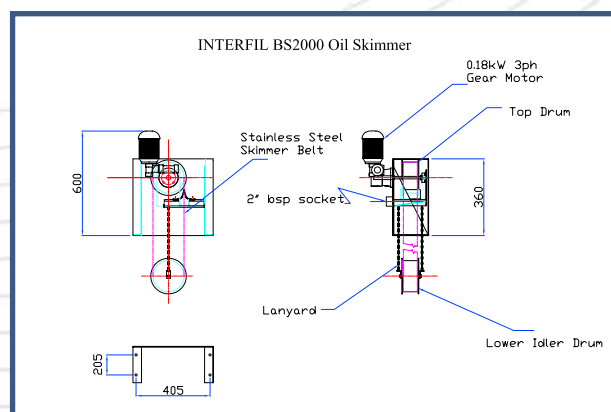

Technical Specifications

Baseframe: Baseframe with integrated collection trays, doctor blades, pedestals and collection sump - the sump having two (2) ports, each of which is machined to 2 inch BSP female thread.

Mounting holes 14mm diameter. are machined into the mounting flanges on a grid 405mm x 205mm to allow mounting with 1/2 inch diameter bolts.

Motor: Three phase, 50 hz, 415 volt, 0.18kw, 4 pole, 1430 rpm, 0.62amps, cont. rates class (E) insulation, TEFC.

Belt: Supplied by vendor steel mill to Interfil's specification, but falling within the general description of stainless steel. The particular properties attributed to the belt are included within the metal and no surface treatment is employed, thus ensuring life-long retention of the inherent properties. Normal width - 200mm.

Fabricated into a continuous belt using special equipment designed for the purpose. Standard belts are furnished in increments of 1/2 metre pulley centre distances - special length upon request.

Tail Pulley: Flanges have overall diameter of 240mm, thus needing a minimum of 250mm fluid depth to allow the tail pulley to operate at the optimum position of fully immersed.

Doctor Blades: Manufactured from nitrile elastomer and assembled into standard units for ease of removal and replacement.

Dimensions

Base overall	450mm x 320mm
Unit overall	450mm x 450mm
Height of baseframe	360mm
Height overall	600mm

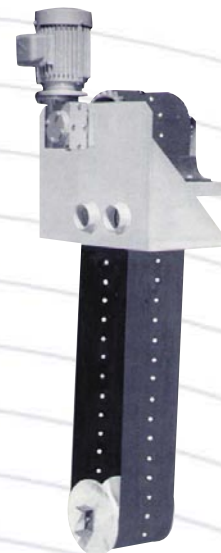

* Interfil liquid Filtration reserves the right to change the design without notice

Contact Us

Phone 02 9533 4433

Fax 02 9534 6313

Email sales@interfil.com.au

Web www.interfil.com.au

2/66 Barry Ave

Mortdale NSW 2223

PO Box 72

Penshurst NSW 2222